

Office Linear Smart Dimming  
Power Supply (Constant Current Type)

- Slim metal housing.
- Overall design complies with Zhaga standards: built-in models meet Zhaga Book 13 and Book 24 specifications, while standalone models meet Zhaga Book 24 requirements.
- Supports DALI-2 DT6/DT8, PUSH DIM/CCT, and corridor lighting dimming/ color temperature adjustment.
- Supports full-command NFC rapid programming, enabling users to modify output current, DALI address, and other parameters via a mobile app using NFC, thereby achieving driver data interaction functionality.
- Supports L-Data functionality, enabling access to DALI Part 251 (luminaire data query), Part 252 (energy report reading), and Part 253 (diagnostic and maintenance data reading) via the DALI master controller, providing robust data support for intelligent management platforms.
- NFC settings feature current step values as low as 1mA, delivering enhanced compatibility and finer control.
- T-PWM ultra-deep dimming technology achieving 0.01% dimming depth.
- 0-100% full-range dimming with zero visible flicker, meeting high-frequency exemption standards.
- Features soft-start gradual brightening for enhanced visual comfort.
- Supports CLO light decay compensation to ensure consistent illumination brightness.
- Supports EL emergency lights; in DC emergency mode, the current defaults to 15%.
- Supports wired firmware upgrades for devices.
- EU ERP no-load power consumption and network standby power consumption < 0.5W.
- 0V output at no load to prevent LED fixture damage from poor contact.
- Over-temperature, over-voltage, overload, and short-circuit protection with automatic recovery.
- Suitable for indoor Class I, II, and III luminaires, such as linear lights, triple-proof lights, floor lamps, bracket lights, and other linear or ultra-thin fixtures.
- Lifespan up to 100,000 hours under normal use.
- 5-year warranty.



Flicker Free  
IEEE 1789

T-PWM  
Dimming Technology



Dimmable:  
1: 10000



L-Data 251/252/253



The certification icon represents undergoing certification applications only, and final certification qualification subject to actual product.



Technical Specs

Model		LF-80-600-2100-G1D2 (Stand-alone)	LF-80-600-2100-G1D2 (Built-in type)	
FEATURES	Output Type	Constant current		
	Dimming Interface	DALI-2 DT6, DALI Part 251/252/253, PUSH DIM		
	Output Feature	Isolation		
	Zhaga Standard	Book 24	Book 13,24	
	Installation Method	Can be independently installed in ceilings or light channels, etc.	Installed inside the luminaire	
	Other Features	EL Emergency Lights, Lumen Maintenance Compensation, Corridor Lighting Applications		
	IP Rating	IP20		
OUTPUT	Insulation Class	Class II (Suitable for class I/II/III light fixtures)		
	Output Voltage	9-54V		
	Max. Output Voltage(No-load)	≤59.5V		
	Rated Current Range	600-2100mA (Set higher current levels via the mobile app's NFC feature, with step increments as low as 1mA; Default: 600mA)		
	Load Power Range	5.4-80W		
	Dimming Range	0~100%, Dimming depth: 0.01%		
	LF Current Ripple	< 5%(Maximum current for non dimming state)		
INPUT	Current Accuracy	±5%		
	PWM Frequency	≤3600Hz		
	AC Voltage Range	220-240V ~		
	DC Voltage Range	220-240V		
	Rated Voltage	230V~		
	Frequency	0/50/60Hz		
	Input Current	≤0.4A/230V ~		
ENVIRONMENT	Power Factor	PF > 0.9/230V~ (Fully loaded)		
	THD	230V~@THD<10% (Fully loaded)		
	Efficiency(Typ.)	88.5%		
	Inrush Current	Cold start20A(Test twidth=215us tested under 50% Ipeak)/230V ~		
	Anti Surge	L-N: 2KV L-FG/N-FG: 4KV		
	Leakage Current	Max.0.5mA		
	PROTECTION	Operating Temperature	ta:-20°C~50°C tc:80°C	
Working Humidity		20~95%RH, non-condensing		
Storage Temperature/Humidity		-40~80°C/10~95%RH		
Temperature Coefficient		±0.03%/°C(-20°C~50°C)		
Vibration		10~500Hz, 2G 12min/1cycle, 72 min for X, Y and Z axes respectively		
SAFETY & EMC	Overload Protection	Automatically protect the device when the load exceeds 102% of the rated power. Automatically recover once load is reduced		
	Overheat Protection	Intelligently adjust or turn off the current output if the PCB temperature ≥110°C. When the PCB temperature <90°C, automatically recover normal output		
	Overvoltage Protection	Automatically protect the device when voltage exceeds the no-load voltage. It can be recovered automatically		
	Short Circuit Protection	Enter hiccup mode if short circuit occurs, and recover automatically		
	Withstand Voltage	I/P-O/P: 3750V~ /1min/ < 5mA, I/P-FG: 1750V~ /1min/ < 5mA, O/P-FG:500V~ /1min/ < 5mA, Signal-FG:500V~ /1min/ < 5mA ①		
SAFETY & EMC	Insulation Resistance	I/P-O/P: 100MΩ/500V~ /1min/25°C/70%RH		
	Safety Certifications	CCC	China	GB19510.1, GB19510.14, GB19510.213
		TUV	Germany	EN61347-1, EN61347-2-13, EN62493
		CB	CB Member States	IEC61347-1, IEC61347-2-13
		CE	European Union	EN61347-1, EN61347-2-13, EN62384
		EAC	Russia	IEC61347-1, IEC61347-2-13
		RCM	Australia	AS 61347-1, AS 61347-2-13
	EMC Emission	ENEC	Europe	EN61347-1, EN61347-2-13, EN62384
		CCC	China	GB/T17743, GB17625.1
		CE	European Union	ENIEC55015, ENIEC61000-3-2, EN61000-3-3
		EAC	Russia	IEC62493, IEC61547, EH55015
	SAFETY & EMC	RCM	Australia	EN55015, EN61000-3-2, EN61000-3-3, EN61547
EMC Immunity		EN61000-4-2,3,4,5,6,8,11,EN61547		
ErP	Power Consumption	Networked standby	< 0.5W(After shutdown by command)	
		No-load power consumption	< 0.5W (When the lamp is not connected)	
	Flicker/Stroboscopic Effect	IEEE1789	Meet IEEE 1789 standard/High frequency exemption level	
		CIE SVM	PstLM≤1.0, SVM≤0.4	
OTHERS	Weight(N.W.)	310g±5g	295g±5g	
	Dimensions	385x30.5x21.3mm(LxWxH)	360x30.5x21.3mm(LxWxH)	

①Note: When performing a withstand voltage test to ground (FG), the gas discharge tube at the drive input must be temporarily removed to prevent functional operation of the internal gas discharge tube (see IEC 60598-1-10.2). After testing is complete, it must be reinstalled to restore surge protection functionality for the power line to ground and ensure reliable contact.

Typical Current Corresponding Parameter Table

The following 31 groups of typical current data are provided for model selection reference. More currents can be set via the mobile phone APP NFC. The settable range is 600-2100mA, and the current step value can be as low as 1mA.									
LF-80-600-2100-G1D2	Output Current	600mA	650mA	700mA	750mA	800mA	850mA	900mA	950mA
	Output Voltage	9-54Vdc	9-54Vdc	9-54Vdc	9-54Vdc	9-54Vdc	9-54Vdc	9-54Vdc	9-54Vdc
	Output Power	5.4-32.4W	5.85-35.1W	3.6-21.6W	6.75-40.5W	7.2-43.2W	7.65-45.9W	8.1-48.6W	8.55-51.3W
	Output Current	1000mA	1050mA	1100mA	1150mA	1200mA	1250mA	1300mA	1350mA
	Output Voltage	9-54Vdc	9-54Vdc	9-54Vdc	9-54Vdc	9-54Vdc	9-54Vdc	9-54Vdc	9-54Vdc
	Output Power	9-54W	9.45-56.7W	9.9-59.4W	10.35-62.1W	10.8-64.8W	11.25-67.5W	11.7-70.2W	12.15-72.9W
	Output Current	1400mA	1450mA	1500mA	1550mA	1600mA	1650mA	1700mA	1750mA
	Output Voltage	9-54Vdc	9-54Vdc	9-53.3Vdc	9-51.6Vdc	9-50Vdc	9-48.5Vdc	9-47.1Vdc	9-45.7Vdc
	Output Power	12.6-75.6W	13.05-78.3W	13.5-80W	13.95-80W	14.4-80W	14.85-80W	15.3-80W	15.75-80W
	Output Current	1800mA	1850mA	1900mA	1950mA	2000mA	2050mA	2100mA	
	Output Voltage	9-44.4Vdc	9-43.2Vdc	9-42.1Vdc	9-41Vdc	9-40Vdc	9-39Vdc	9-38.1Vdc	
	Output Power	16.2-80W	16.65-80W	17.1-80W	17.55-80W	18-80W	18.45-80W	18.9-80W	

Product Size

Unit: mm

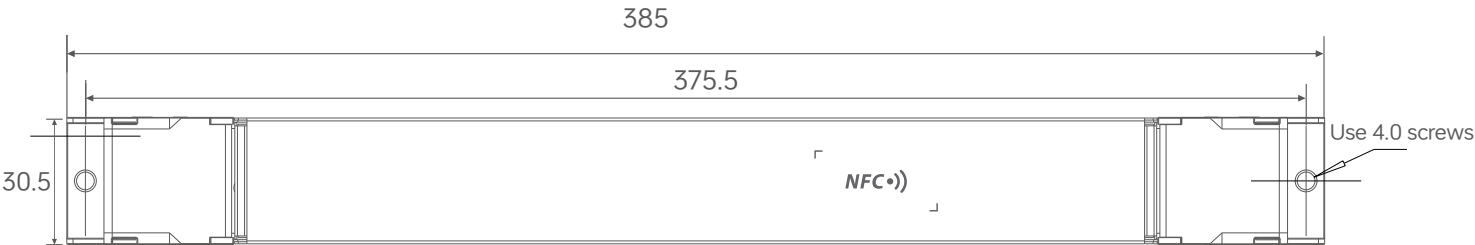

Stand-alone

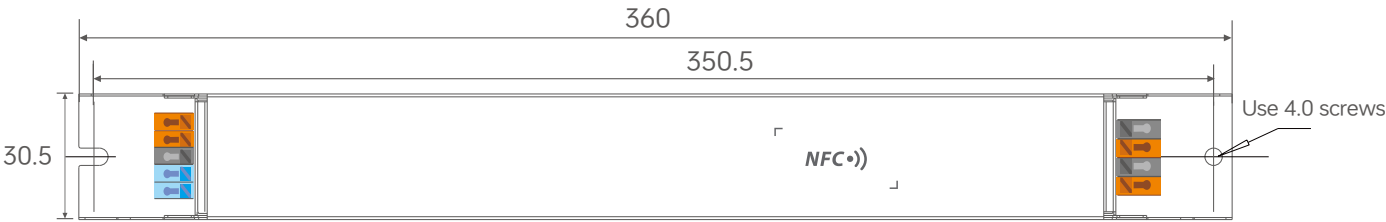

Built-in type

Connectivity Diagram

DALI Connection Method

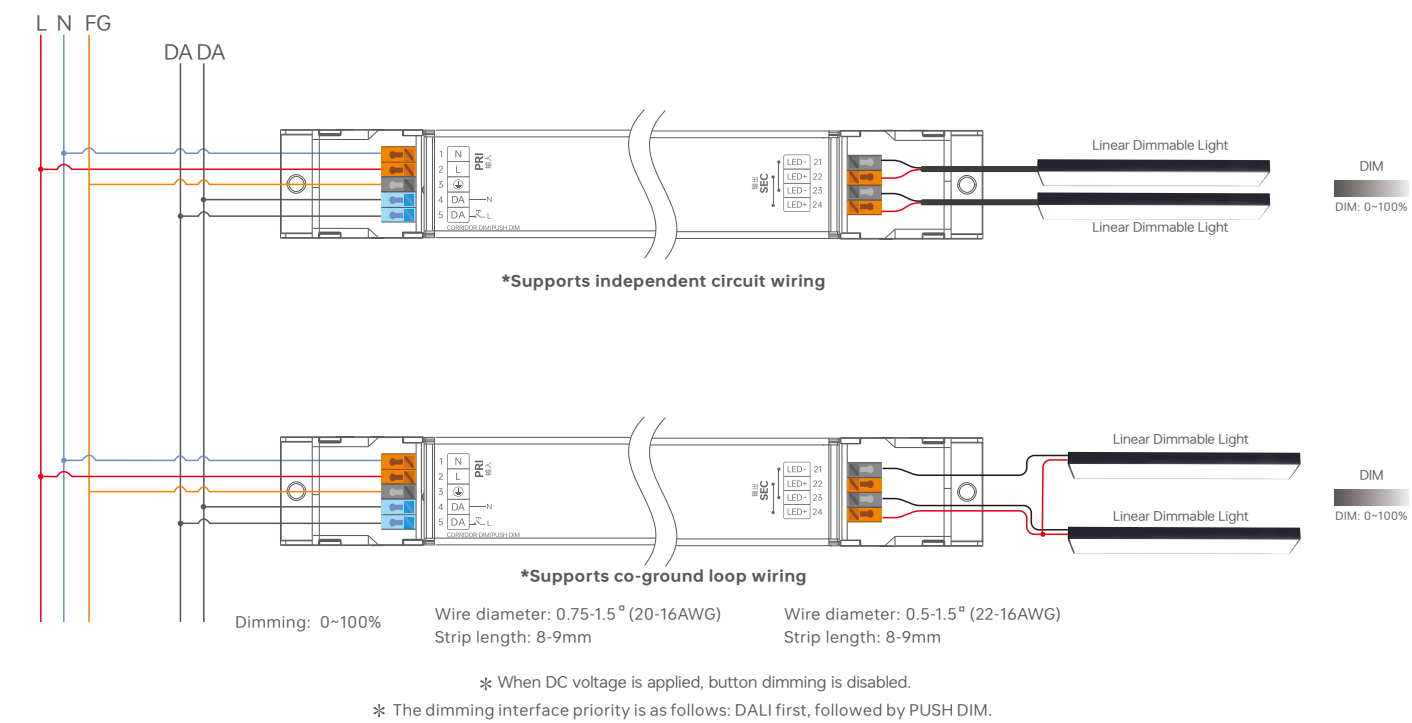

Switch to DALI dimming mode

After installation according to the DALI dimming application wiring diagram, the driver will automatically switch to DALI dimming mode upon receiving any DALI command.

PUSH DIM Connection Method

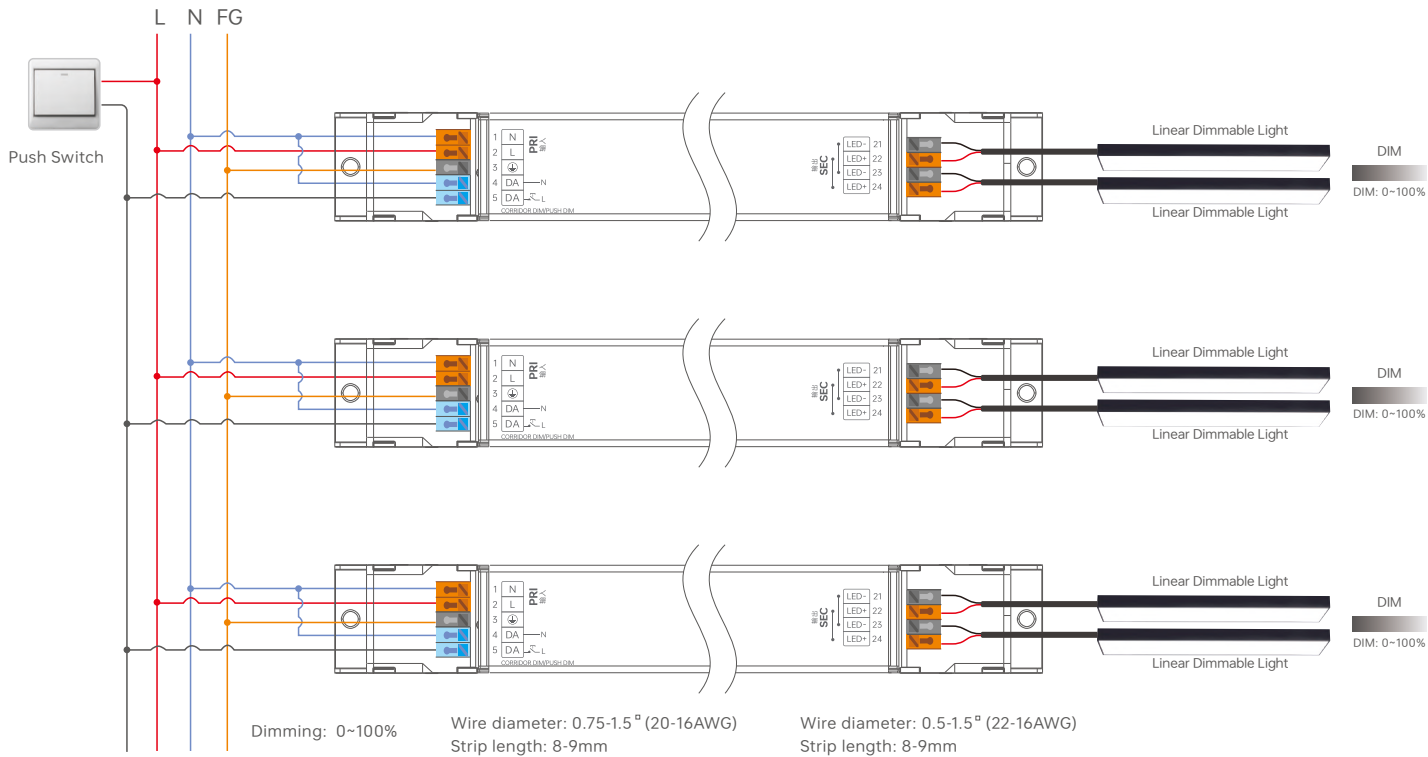

Push Switch

Operation Instructions

- Short press : on/off control.
- Long press: Brightness adjustment +/-, each subsequent long press will adjust the brightness in the opposite direction.
- Dimming Memory: When switched on or off again, the light will return to the previously adjusted brightness level.

Switch to PUSH DIM dimming mode

Method 1: If already switched to Corridor Dimming mode, connect the wiring according to the PUSH DIM wiring diagram. Reset the switch by pressing it 5 times within 3 seconds, then hold it down for 6 seconds, followed by pressing it 5 times within 3 seconds. The driver will automatically switch to PUSH DIM dimming mode.

Method 2: If already switched to Corridor Mode, you can switch to PUSH DIM dimming mode via the NFC Lighting app.

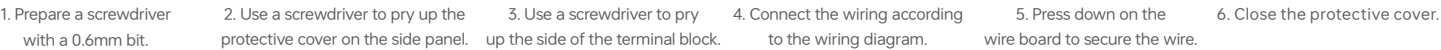

Installation Precautions

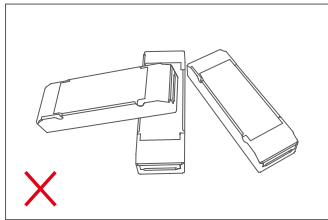

Please do not stack the products. The distance between two products should be  $\geq 15\text{cm}$  so as not to affect heat dissipation or the lifetime of the products.

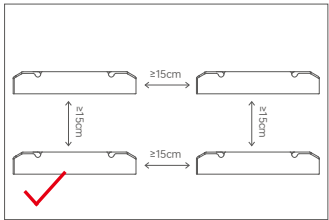

Note: Installation must comply with the product's operating temperature range. Do not install inside lighting fixtures to avoid exceeding the product's operating temperature range, which may affect its lifespan.

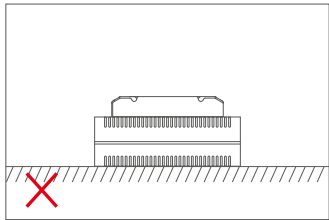

Please not place the products on power supplies. The distance between the product and the power supplies should be  $\geq 15\text{cm}$  so as not to affect heat dissipation or shorten the lifetime of the products.

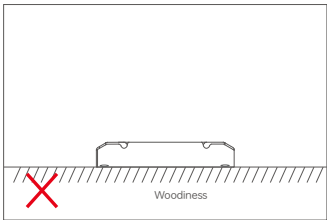
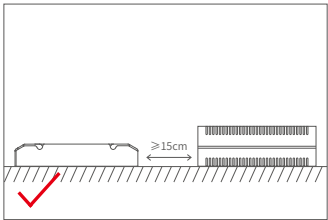

Do not fix the product screws tightly against the wooden board. Instead, add a washer with a thickness of  $\geq 7\text{mm}$  under the fixing screws. Leaving some gaps can effectively dissipate heat, preventing any impact on the product's heat dissipation performance and service life.

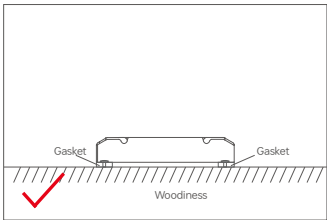

Use the NFC Lighting APP

Scan the QR code below with your mobile phone and follow the prompts to complete the APP installation (According to performance requirements, you need to use a NFC-capable Android phone, or an iphone 8 and later that are compatible with iOS 13 or higher).



\* Before you begin setting the parameters of the driver, please make sure the driver is powered off.

Read/Write the LED driver

Use your NFC-capable phone to read LED driver data, then edit the parameters and they can be directly written to the driver.

1.Read the LED driver

On the APP home page, click 【Read/Write LED driver】 , then keep the programmer's sensing area close to the NFC sensing area of the driver to read the driver parameters.

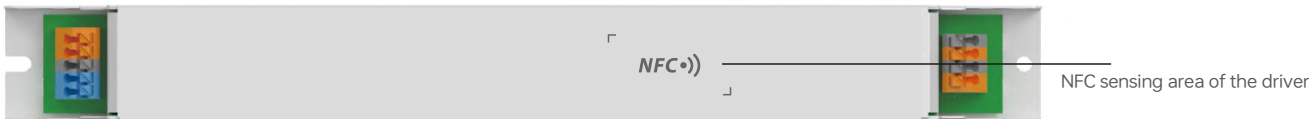

2. Edit parameters

Click on [Parameter Management] to edit more advanced parameters such as Output Current, DALI Address, Dimming Curve, Brightness Range, Time for Fading to Dim Level, Power-on Status, System Failure Level, Light Decay Compensation, Corridor Lights, EL Emergency Light, Advanced DALI Template and Corridor Light.

3. Write to the drive

After completing the parameter settings, click 【Write】 in the upper right corner, and keep the programmer's sensing area close to the NFC sensing area of the driver, so the parameters can be written to the driver.

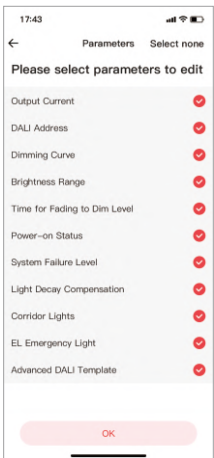
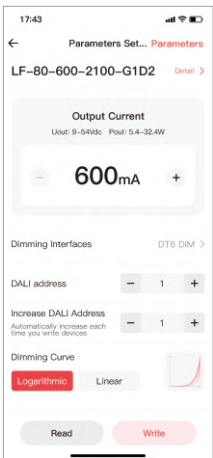
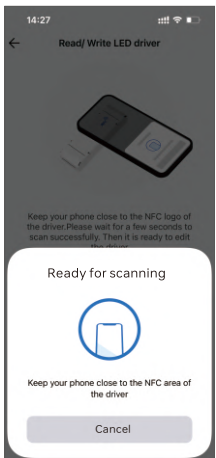

Advanced DALI template

Integrate the functions of the DALI lighting system, edit the DALI group and lighting effects for scenes, then save them in the advanced template to achieve lighting programming.

Setup page (for Read/Write LED driver) : Go to App home page —  icon in the top right — **[DALI template on phone]** .

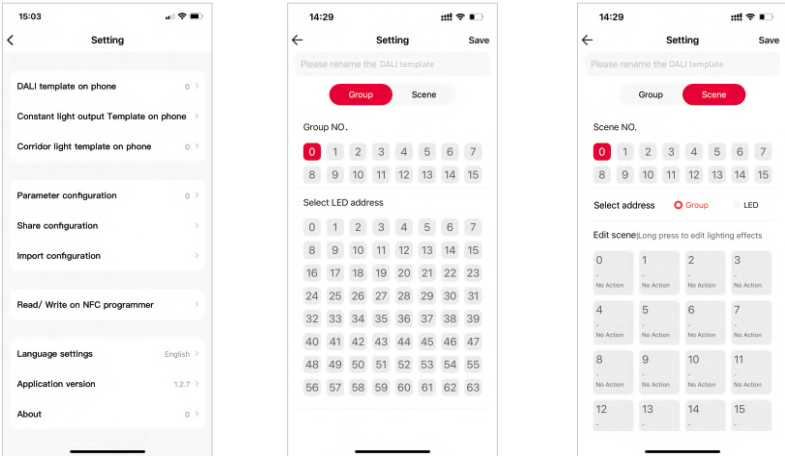

Light Decay Compensation

Lumen Maintenance Compensation primarily serves to sustain constant luminous flux output from LEDs. Throughout the LED's entire lifespan, it gradually increases the drive current to counteract lumen depreciation caused by prolonged operation, thereby ensuring consistent light output.

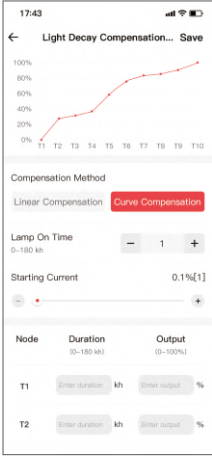

EL Emergency Light

- The power supply operates normally with DC input.
- When using DC input, connect the positive terminal of the DC cable to the L terminal and the negative terminal to the N terminal.
- The output current can be configured via the NFC lighting app.

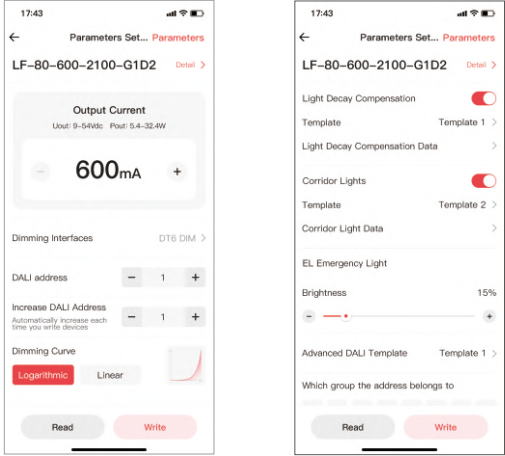

Relationship Diagrams

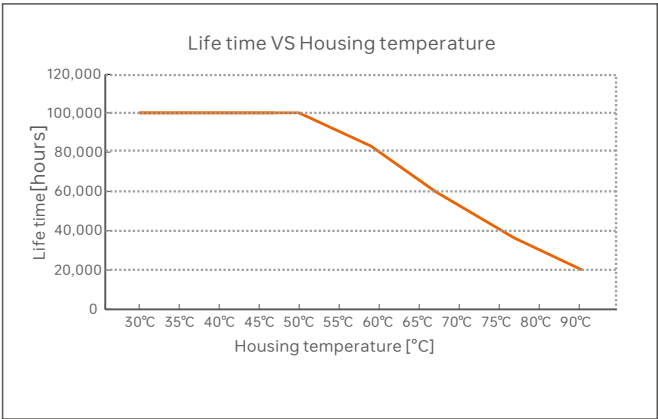
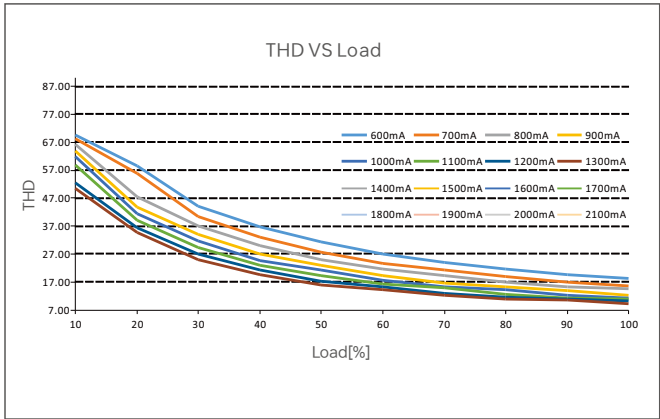
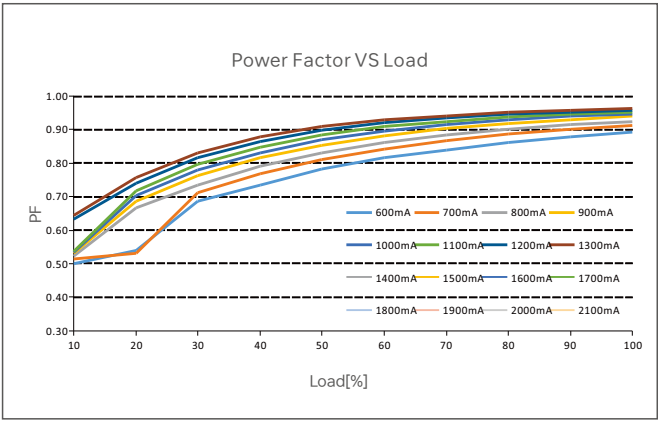
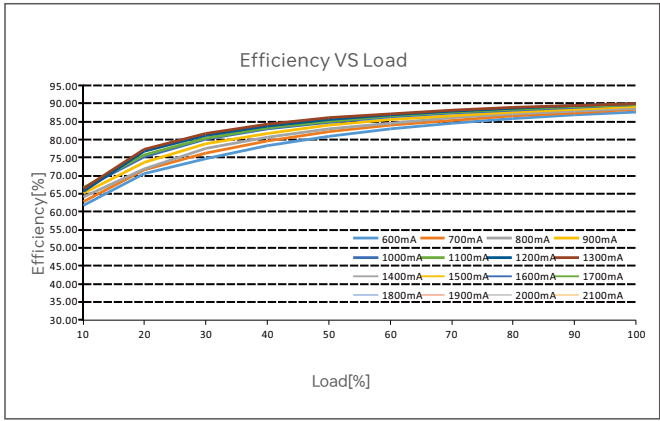



Surge Current & Corresponding Miniature Circuit Breaker (MCB) Load Capacity Table

MCB Model	B10	B13	B16	B20	B25	C10	C13	C16	C20	C25	D10	D13	D16	D20	D25
Maximum Load Capacity	15	19	24	30	40	17	22	27	35	43	20	25	31	39	49

Remarks:

1. Test Conditions: Cold start 20A(Test twidth=215us tested under 50% Ipeak)/230V ~ .
2. The number of supported drivers may vary depending on the brand and model of the MCB.
- 3.It is recommended not to exceed the specified load capacity during on-site installation. The actual load should be determined based on field conditions.
- 4.If the ambient temperature exceeds 30°C or multiple MCBs are installed side by side, the number of installed drivers must be reduced and recalculated accordingly.
- 5.Electricians typically use Type B MCBs for residential lighting and Type C MCBs for commercial lighting applications.
- 6.Different testing equipment may yield variations in measured current peaks and pulse widths. Always use professional-grade instruments for accurate testing.

Flicker Test Sheet

IEEE 1789

Limit of modulation in low risk area	
Waveform frequency of optical output	limit (%)
$f \leq 8\text{Hz}$	0.2
$8\text{Hz} < f \leq 90\text{Hz}$	$0.025 \times f$
$90\text{Hz} < f \leq 1250\text{Hz}$	$0.08 \times f$
$f > 1250\text{Hz}$	Exemption assessment
Limit of modulation in no effect area	
Waveform frequency of optical output	limit (%)
$f \leq 10\text{Hz}$	0.1
$10\text{Hz} < f \leq 90\text{Hz}$	$0.01 \times f$
$90\text{Hz} < f \leq 5125\text{Hz}$	$(0.08/2.5) \times f$
$f > 3125\text{Hz}$	Exemption assessment (High frequency exemption)

- Brightness
- ▲

0.1%
- ◆

1%
- ▲

5%
- ◆

10%
- 20%
- 30%
- 40%
- ★

50%
- 60%
- 70%
- 80%
- ★

90%
- ◆

100%

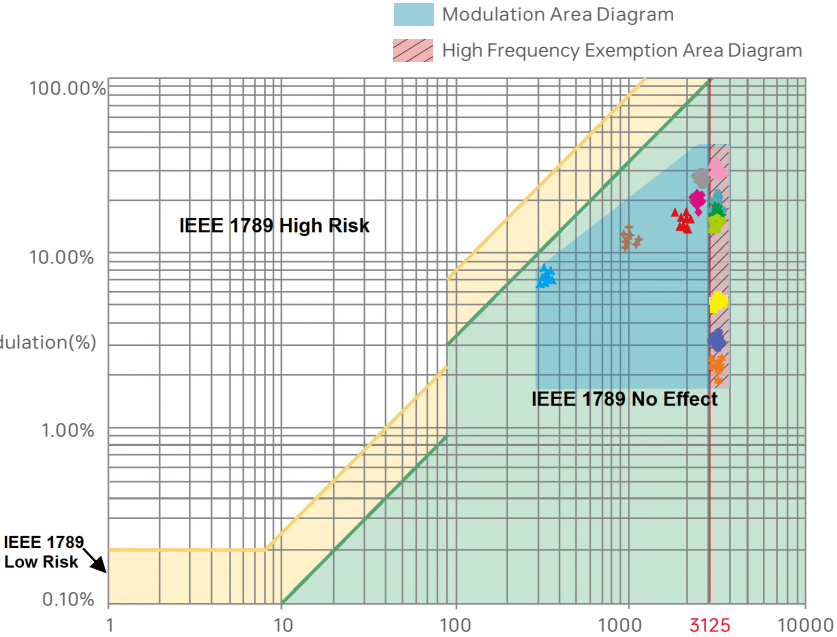

Marks in the right chart were tested results of different current ranges. The output frequency is 0Hz in 100% brightness and its corresponding modulation is 0%, which could not be shown in the right chart.

Packaging Specification

Model	LF-80-600-2100-G1D2
Packaging box size	405×255×140mm(L×W×H)

Packaging Style Drawing

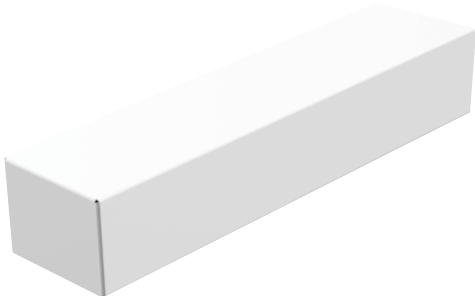

Inner packaging box



Full box packaging

## Transportation and Storage

### 1. Transportation

Products can be shipped via vehicles, boats and planes.

During transportation, products should be protected from rain and sun. Please avoid severe shock and vibration during the loading and unloading process.

### 2. Storage

The storage conditions should comply with the Class I Environmental Standards. The products that have been stored for more than six months are recommended to be re-inspected and can be used only after they have been qualified.

## Attentions

- Product installation and commissioning should be done by a qualified professional.
- LTECH products are and not lightningproof non-waterproof (special models excepted). Please avoid the sun and rain. When installed outdoors, please ensure they are mounted in a water proof enclosure or in an area equipped with lightning protection devices.
- Good heat dissipation will prolong the working life of products. Please ensure good ventilation.
- Please check if the working voltage used complies with the parameter requirements of products.
- The diameter of wire used must be able to load the light fixtures you connect and ensure the firm wiring.
- Before you power on products, please make sure all the wiring is correct in case of incorrect connection that causes damage to light fixtures.
- If a fault occurs, please do not attempt to fix products by yourself. If you have any question, please contact your suppliers.
- \* This manual is subject to changes without further notice. Product functions depend on the goods. Please feel free to contact our official distributors if you have any question.

## Warranty Agreement

- Warranty periods from the date of delivery: 5 years.
- Free repair or replacement services for quality problems are provided within warranty periods.

Warranty exclusions below:

- Beyond warranty periods.
  - Any artificial damage caused by high voltage, overload, or improper operations.
  - Products with severe physical damage.
  - Damage caused by natural disasters and force majeure.
  - Warranty labels and barcodes have been damaged.
  - No any contract signed by LTECH.
1. Repair or replacement provided is the only remedy for customers. LTECH is not liable for any incidental or consequential damage unless it is within the law.
2. LTECH has the right to amend or adjust the terms of this warranty, and release in written form shall prevail.

### Update Log

Version	Updated Time	Update Conten	Updated by
A0	20251111	Original version	Haipeng Li