



# EB Series Touch Panels

Model: EB1 / EB2 / EB5



Manual

[www.ltech-led.com](http://www.ltech-led.com)

# Product Introduction

- Adopts a two-in-one control method combining Bluetooth 5.2 SIG Mesh wireless protocol and DMX512 protocol, providing greater flexibility and convenience for engineering applications.
- 4-zone dimming touch panel with DMX512 master control, adjusted via a touch color ring.
- The function area keys can be set as single-zone or multi-zone panels through the APP.
- Paired with the L-Home APP, it enables control over lighting on/off, dimming, and color adjustment.
- When paired with a smart gateway, it supports a variety of control methods, including rich cloud scenarios, cloud automation, and local automation.
- Supports local scenarios. It can be controlled without a gateway and remains operational even when the network is down, ensuring faster and more stable performance.
- Compatible with European standard back boxes and Chinese national standard 86 back boxes.

## Specification Parameters

Model	EB1	EB2	EB5
Control Type	DIM	CT	RGB/RGBW/RGBCW
Output Voltage	100-240V~		
Output Signal	DMX512		
Wireless Type	Bluetooth 5.2 SIG Mesh		
Compatible Remote Control	B1	B2	B5
Compatible Driver	B5-3A,DMX decoder		
Working Temperature	-25°C~50°C		
Dimensions	86×86×36mm (L×W×H)		
Package Size	113×112×50mm (L×W×H)		
Product Weight	155g		



SRRC

CE

FC

RoHS

# Product Size

Unit: mm

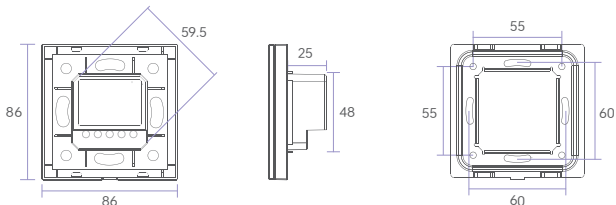

## Product Illustration



Front View

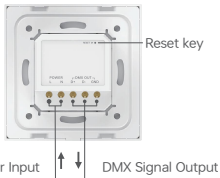

**Factory Reset:** Use a SIM ejector pin to press and hold the reset key on the back of the panel for 6 seconds until all the indicator lights on the panel flash and then turn off, indicating that the factory settings have been restored.

# Panel Button Instructions

## EB1

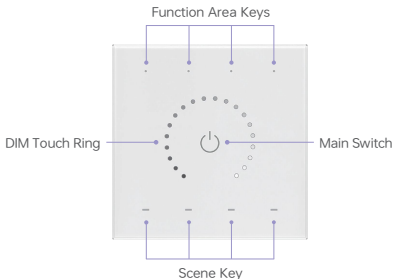

**Function Area Keys:** In single-zone mode, the area keys become brightness shortcut keys: 25%, 50%, 75%, 100%. In multi-zone mode, there are 4 area keys. Click to turn on, select/deselect the current zone; long-press to turn off the current zone. (To switch zones, reset the device and modify the settings when reconnecting to the network via the L-Home APP.)

**DIM Touch Ring:** Adjusts brightness by touch.

**Main Switch:** Click to turn all lights on or off.

**Scene Key:** Click the touch button to trigger a scene. Scenes need to be bound through the L-Home APP, and it supports local scenes (with no restrictions on scene lighting types) and DALI scenes.

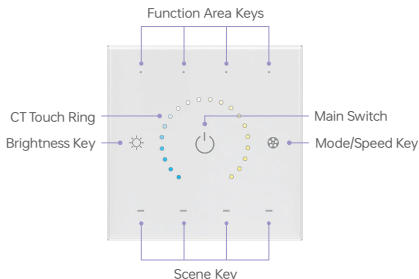

**Function Area Keys:** In single-zone mode, the area keys become brightness shortcut keys: 25%, 50%, 75%, 100%. In multi-zone mode, there are 4 area keys. Click to turn on, select/deselect the current zone; long-press to turn off the current zone. (To switch zones, reset the device and modify the settings when reconnecting to the network via the L-Home APP.)

**CT Touch Ring:** Adjusts CT by touch.

**Main Switch:** Click to turn all lights on or off.

**Brightness Key:** Click to adjust brightness (about 5 levels); long-press to adjust CT brightness (long-press to gradually increase brightness, release and long-press again to gradually decrease brightness).

**Mode/Speed Key:** Click to play/switch the "Normal Mode" in the APP; long-press to adjust the mode speed.

**Scene Key:** Click the touch button to trigger a scene. Scenes need to be bound through the L-Home APP, and it supports local scenes (with no restrictions on scene lighting types) and DALI scenes.

## EB5

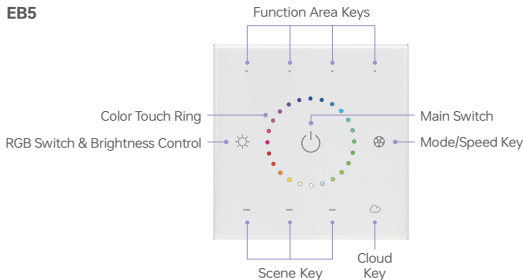

**Function Area Keys:** In single-zone mode, the area keys become brightness shortcut keys: 25%, 50%, 75%, 100%. In multi-zone mode, there are 4 area keys. Click to turn on, select/deselect the current zone; long-press to turn off the current zone. (To switch zones, reset the device and modify the settings when reconnecting to the network via the L-Home APP.)

**Color Touch Ring:** Adjusts color by touch.

**Main Switch:** Click to turn all lights on or off.

**RGB Switch & Brightness Control:** Click to turn RGB on/off; long-press to adjust brightness.

**Mode/Speed Key:** Click to play/switch the "Normal Mode" in the APP; long-press to adjust the mode speed.

**Scene Key:**

- ① "R/G/B" click to turn on the current channel, long-press the channel to adjust brightness. The default R/G/B button functions support individual adjustment and on/off of the RGB function, and each button can be bound to a scene.
- ② Click the touch button to trigger a scene. Scenes need to be bound through the L-Home APP, and it supports local scenes (with no restrictions on scene lighting types) and DALI scenes.

**Cloud Key:**

- ① When it is an RGB panel, a single click is invalid, long-press to adjust RGB saturation;
- ② When it is an RGBW panel, a single click turns W on/off, long-press to adjust W;
- ③ When it is an RGBCW panel, a single click turns CW on/off, long-press to adjust CW.

# Installation Steps

- ① Turn off the main power switch. Make sure there is no cement or other attachments on the inner wall of the 86 flush-mounted box. Trim the length of the power cord in the box to about 10CM. Use a flat-head screwdriver to pry open the bottom box of the touch panel.



- ② Connect the live wire to the L interface of the touch panel and the neutral wire to the N interface. Ensure that the power cord makes good contact with the switch terminals and that there are no exposed copper wires. (The front - end protection device of the electronic switch should not exceed 35A.)



- ③ Fix the bottom box to the wall flush-mounted box with screws, making the bottom box fit tightly against the wall.

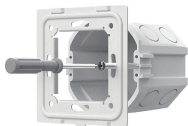

- ④ Tilt the panel and snap it onto the bottom box. Turn on the main power switch. Press the touch panel. If the lights can be controlled normally, it indicates that the installation is correct.





# Recommended Application Combinations

① Wireless - controlled lighting fixtures.

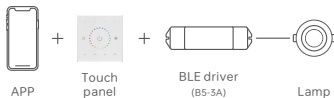

② Wireless + wired control for stable and reliable signals.

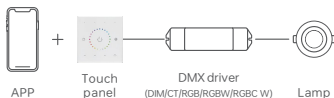

③ Wireless + Bluetooth local scenes to enrich different lighting applications.

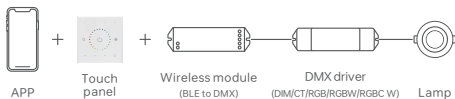

④ Visual control + traditional dimming panel remote control.

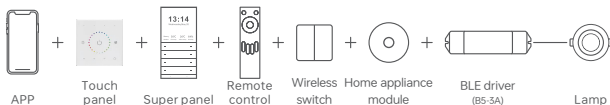

⑤ More applications of intelligent control are waiting for you to set up.

# Bluetooth Application Schematic Diagram

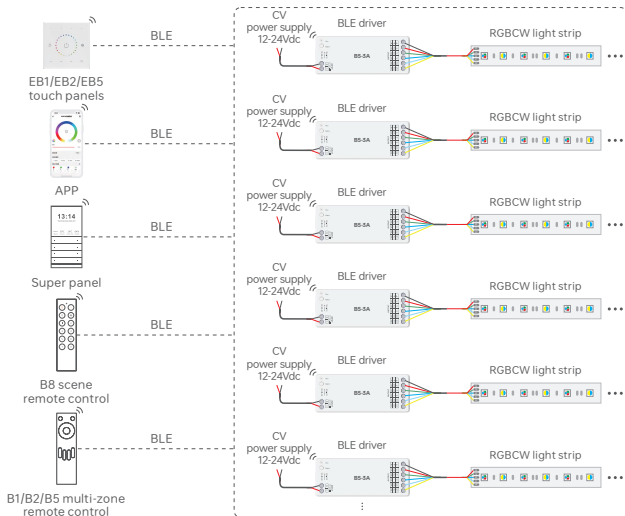

\* For a better product experience, it is not recommended to use both the wired DMX output of the panel and the wireless Bluetooth driver at the same time.

\* Please try to avoid placing the wireless drive next to large metal objects or using it in a space with a lot of metallic media, so as not to have the signal interfered with and affect its usage.

# Schematic Diagram Of DMX Application

## ① Single zone

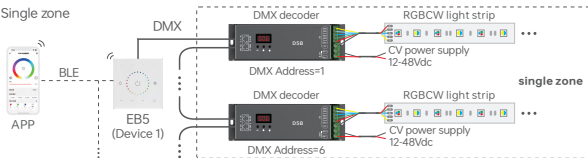

## ② Multiple zones

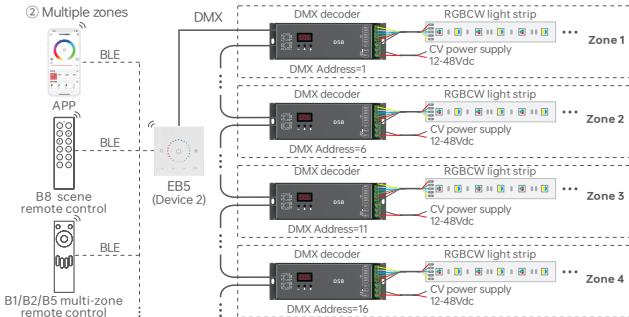

\* If there are more than 32 DMX decoders connected, a DMX signal amplifier should be added, and the signal amplification should not be continuous for more than 5 times. When there are more than 32 DMX/RDM decoders connected, if it is necessary to modify their parameter settings, one RDM signal amplifier can be added, or after the parameter settings are completed, 1 to 5 DMX signal amplifiers can be added.

\* When the signal recoil effect affects the usage due to reasons such as a long signal line or the quality of the wire, you can try to connect a 0.25W 90-120Ω terminal resistor at the end of each signal line to solve the problem.

# DMX Single - Zone Channel Output Table

Type Address	DIM	CT	CT2	RGB	RGBW	RGBCW
1	DIM	C	BRT	R	R	R
2	DIM	W	CT	G	G	G
3	DIM	C	BRT	B	B	B
4	DIM	W	CT	R	W	C
5	DIM	C	BRT	G	R	W
6	DIM	W	CT	B	G	R
7	DIM	C	BRT	R	B	G
8	DIM	W	CT	G	W	B
9	DIM	C	BRT	B	R	C
10	DIM	W	CT	R	G	W
11	DIM	C	BRT	G	B	R
12	DIM	W	CT	B	W	G
13	DIM	C	BRT	R	R	B
14	DIM	W	CT	G	G	C
⋮	⋮	⋮	⋮	⋮	⋮	⋮
500	DIM	W	CT	G	W	W
⋮	⋮	⋮	⋮	⋮	⋮	/
512	DIM	W	CT	G	W	/

\* According to the illustration in the above figure, and so on.

# DMX Multi - Zone Channel Output Table

Address \ Type Zone	DIM	CT	CT2	RGB	RGBW	RGBCW
1	DIM1	C1	BRT1	R1	R1	R1
2	DIM2	W1	CT1	G1	G1	G1
3	DIM3	C2	BRT2	B1	B1	B1
4	DIM4	W2	CT2	R2	W1	C1
5	DIM1	C3	BRT3	G2	R2	W1
6	DIM2	W3	CT3	B2	G2	R2
7	DIM3	C4	BRT4	R3	B2	G2
8	DIM4	W4	CT4	G3	W2	B2
9	DIM1	C1	BRT1	B3	R3	C2
10	DIM2	W1	CT1	R4	G3	W2
11	DIM3	C2	BRT2	G4	B3	R3
12	DIM4	W2	CT2	B4	W3	G3
13	DIM1	C3	BRT3	R1	R4	B3
14	DIM2	W3	CT3	G1	G4	C3
⋮	⋮	⋮	⋮	⋮	⋮	⋮
500	DIM4	W2	CT2	G3	W1	W4
⋮	⋮	⋮	⋮	⋮	⋮	/
512	DIM4	W4	CT4	G3	W4	/

\* For DIM, four partitions cycle every 4 addresses. For CT and CT2, four partitions cycle every 8 addresses. For RGB, four partitions cycle every 12 addresses. For RGBW, four partitions cycle every 16 addresses. For RGBCW, four partitions cycle every 20 addresses. Follow the indication in the above diagram, and so on.



### 3. Applications of single-zone and multi-zone

On the "Room" interface, click the added touch panel to enter the [Control] interface.

**In the single-zone mode:** Click "Bind Area", select the device to bind, and you can bind lights or light groups. Brightness shortcuts can be set to four percentage levels: 25%, 50%, 75%, and 100%. Click the "... " button in the scene, select "Bind Scene", and you can bind " Save Current Scene", "Local Scene", or "DALI Scene". Single-click a card to execute the scene; long-press the card or click "... " to unbind the scene.

**In the multi-zone mode:** Zone actions: Short-press to turn on, select, or deselect a partitioned zone. Long-press to turn off the zone. Click the "... " button in the zone to bind devices, activate the current zone, or customize the name.

**Scene actions:** Single-click a card to execute the scene. Long-press the card or click "... " to bind or unbind the scene.

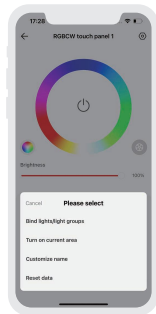
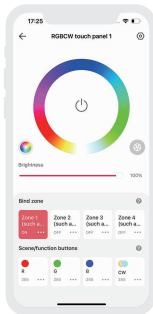
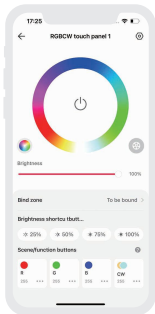

#### 4. Be bound by the remote control

The touch panel EB1 can be bound to the B1 remote control, the EB2 can be bound to the B2 remote control, and the EB5 can be bound to the B5 remote control.

Each partition of the remote control corresponds to each partition of the touch panel.

After binding, the remote control zone will control the load of the touch panel.

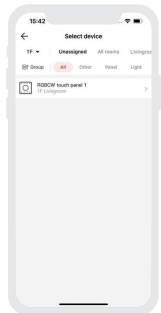
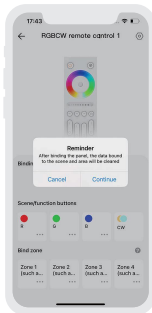
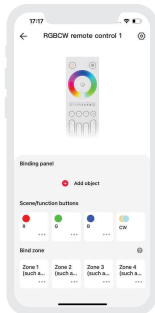



## 5. Local scene

Create a local scene:

Switch to the **【Smart】** page, click "+" in the upper right corner to create a local scene, and after setting the execution action, you can realize the local linkage of Bluetooth devices.

Binding local scenes:

On the control details page, click on the corresponding key, and set the binding scene. Once saved successfully, a short press of the button will immediately execute the bound scene.

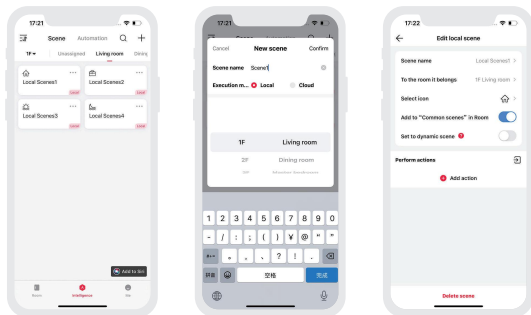

## 6. Cloud scenes and automation

Make sure that a smart gateway, such as Super Panel 12S, has been added to the family.

Cloud scenes:

Switch to the **【Smart】** interface and click “+” to create a cloud scene. After setting the execution action, remote linkage can be achieved.

Automation:

Select “Automation” in the **【Smart】** page and click “+” to create automation. You can choose local/cloud execution mode, and set trigger conditions and execution actions. When the set trigger conditions are met, a series of device actions are automatically triggered to achieve remote linkage.

Note: Touch panels can be set as trigger conditions or as execution actions.

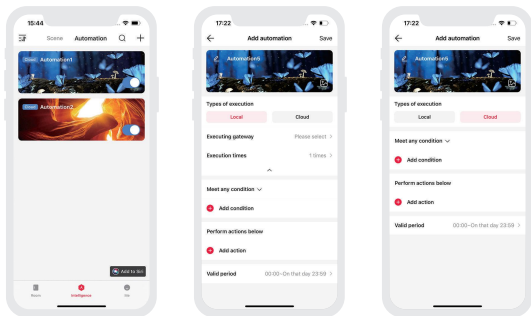

# Restore To Factory Settings

**Method 1:** After the EB - series (EB1/EB2/EB5) touch panel is connected to power, use a SIM - card - eject tool to long - press the reset key on the back of the panel for 6 seconds (see Figure 1). When all the indicator lights on the panel flash and then go out, it indicates that the factory settings have been restored.

**Method 2:** First, make sure that the device is properly powered on and in an online state. Then, open the L - Home APP, find the device, and enter its settings page. Click the "Delete Device" button (see Figure 2). When the system prompts "Deletion successful", it means that the device has been successfully restored to its factory settings.



Figure 1

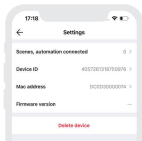

Figure 2

## FAQs

### 1. What to do if the network configuration fails?

- ① Ensure that the device is powered on normally.
- ② Confirm that the device being added has not been added by another account. If it has been added, please manually restore the factory settings.
- ③ Ensure that the mobile phone and the device are as close as possible, preferably within 15 meters.
- ④ If the device has been forcibly deleted, please manually restore the factory settings and then add the device again.

### 2. How to remotely control the device?

When paired with our company's Smart gateway, the device can be remotely controlled via 4G/5G/WiFi on a mobile phone.

# Attentions

- Product installation and commissioning should be done by a qualified professional.
- LTECH products are and not lightningproof non-waterproof (special models excepted). Please avoid the sun and rain. When installed outdoors, please ensure they are mounted in a water proof enclosure or in an area equipped with lightning protection devices .
- Good heat dissipation will prolong the working life of products. Please ensure good ventilation.
- Please check if the working voltage used complies with the parameter requirements of products.
- The diameter of wire used must be able to load the light fixtures you connect and ensure the firm wiring.
- Before you power on products, please make sure all the wiring is correct.
- If a fault occurs, please do not attempt to fix products by yourself. If you have any question, please contact your suppliers.

# Warranty Agreement

- Warranty periods from the date of manufacture: 5 years.
- Free repair or replacement services for quality problems are provided within warranty periods.

Warranty exclusions below:

Following conditions are not within the guarantee range of free repairing or replacement services:

- Beyond warranty periods.
  - Any artificial damage caused by high voltage, overload, or improper operations.
  - Products with severe physical damage.
  - Damage caused by natural disasters and force majeure.
  - Warranty labels and barcodes have been damaged.
  - No any contract or invoice signed by LTECH .
1. Repair or replacement provided is the only remedy for customers. LTECH is not liable for any incidental or consequential damage unless it is within the law .
  2. LTECH has the right to amend or adjust the terms of this warranty. The warranty that issues in writting shall prevail.
- \* This manual is subject to changes without further notice. Product functions depend on the goods. Please feel free to contact our official distributors if you have any question.