

Switch Module

Model: KMS1

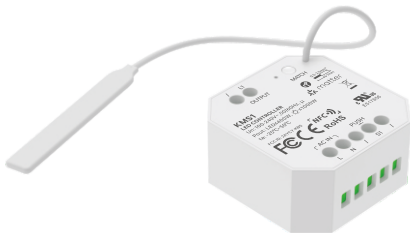

Manual

Product Introduction

- Fully supports major smart home ecosystems including Apple Home, SmartThings, Google Assistant, and Amazon, enabling unified management across platforms.
- Built-in Thread module, compatible with the Matter protocol, supports Siri, Google, and Alexa voice control.
- Supports OTA firmware updates to continuously receive the latest features and security patches, ensuring long-term device stability.
- Parameter settings for switch type and power-on status can be completed via the NFC Lighting App.
- Reserved mechanical switch/reset switch interface accommodates both traditional operating habits and smart scenario requirements.

Technical Specs

Model	KMS1
Wireless type	Matter over Thread
Switch channel	1CH
Operating voltage	100-240V~, 50/60Hz, μ
Max. load parameters of the relay	Resistive load: 1000W@230Vac, 500W@110Vac Capacitive load: 400W@230Vac, 200W@110Vac
Relay surge current	70A@10ms
Working temperature	-25°C~50°C
Product size	L45×W45.5×H20.5(mm)
Product weight	38g
Standards	UL 8750、EN 61347-2-13:2014+A1:2017、EN 61347-1:2015+A1:2021、 EN 62493:2015/A1:2022



matter



RoHS



Product Images

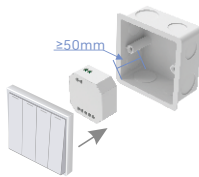
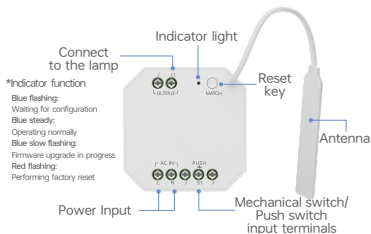

Hide this product inside a junction box.

*Requires installation in a box with a depth of $\geq 50\text{mm}$

Product Size

Unit: mm

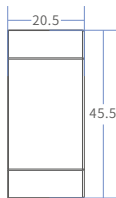
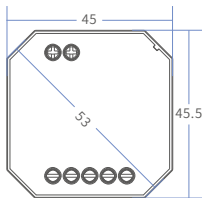

Wiring Diagram

1. Mechanical Switch Wiring Diagram

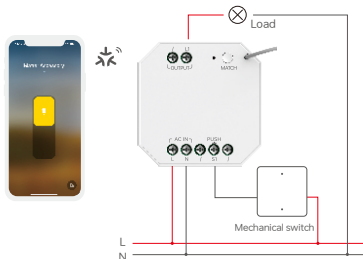

2. Push Switch Wiring Diagram

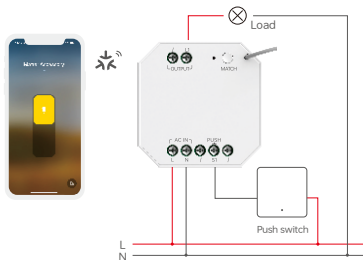

Use the NFC Lighting APP

Scan the QR code below with your mobile phone and install the APP as prompted.

(Due to performance requirements, the required phone model is Apple: iPhone8 or above, and the operating system iOS13 or above; Android: NFC enabled models).



Scan code download APP
IOS/Android



NFC sensing area

***When setting device parameters,
Perform this operation only when
the device is powered off.**

1. Read the device

Click "Read/Write LED driver" in the APP [home page], place the sensing area of the phone near the NFC identification point of the driver, and read the device parameters.

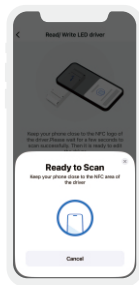

2. Edit Parameters



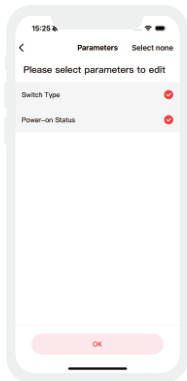
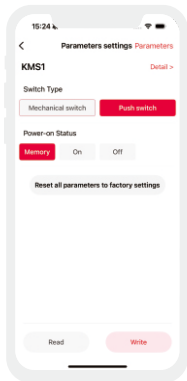

Click “Parameter Management” to select the switch type. When selecting a reset switch, you can configure the device’s power-on state function.



3. Add to Matter Platform Instructions

1.This device supports control via major smart home platforms, including Apple Home, Amazon Alexa, Google Home, SmartThings, and others.

2.To connect Matter over Thread devices, you need to prepare a Matter hub supporting Thread border router functionality from major platforms. Refer to the image below for compatible models.

 Apple Home	 Google Home	 Amazon Alexa	 SmartThings
Apple HomePod (second-gen)	Google Ne.st Hub (2nd Gen)	Amazon Echo (4th-gen)	Aeotec SmartThings Smart Home Hub
Apple HomePod Mini	Google Nest Hub Max	Amazon Echo Hub	Samsung SmartThings Station
Apple TV 4K (2nd gen)	Google Nest Wifi Pro	Amazon Echo Show 8 (3rd-gen)	Samsung SmartThings Hub Dongle
Apple TV 4K (3rd gen,128 GB)	Google TV Streamer (4K)	Amazon Eero 6, Pro 6, 6 Plus, Max 7 etc.	Samsung SmartThings Hub v3

3.This guide uses Apple Home as an example. First, prepare an iPhone (iOS 16.2 or later) or iPad (iPadOS 16.2 or later) with the latest firmware, along with an Apple HomePod mini also running the latest firmware. Then connect your iPhone or iPad to your home Wi-Fi network, launch the Apple Home app, and follow Apple's instructions to set up the HomePod mini.

*For iPhone models 15 and above, no Matter hub is required; they can be added directly.

4. Add accessories

Open the Apple Home app and tap “Add or Scan Accessories.” Add the device to Apple Home by scanning the QR code sticker on the device, as shown below.

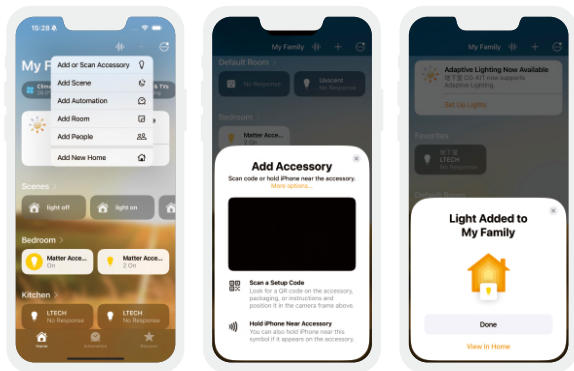

*You can also activate service via NFC: Simply hold your iPhone 16 or later model near the device's NFC sensor area to be recognized and activated.

5. Control device

After successfully adding the device to Apple Home, tap the device icon to turn it on or off.

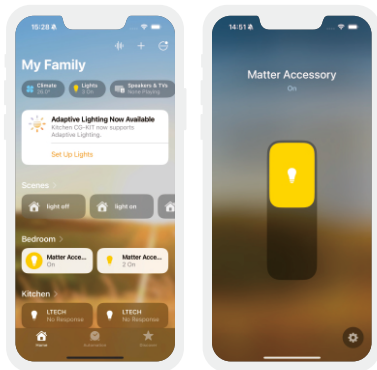

6. Advanced Features

Supports creating groups, scenes, and automations, as well as remote control and scheduled control. Devices can also be controlled via Siri voice commands.

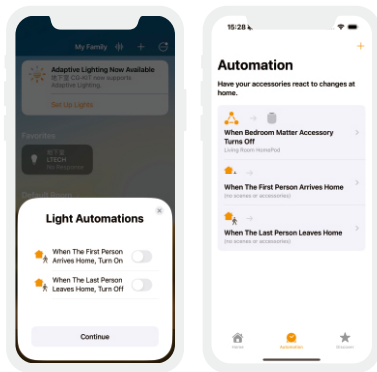

7. Restore factory settings

Reset button reset: Press and hold the reset button for 15 seconds until the indicator light flashes red rapidly, then release. Within 3 seconds, press the reset button three times briefly. The red light will then switch to slow flashing, indicating the device has begun restoring factory settings. When the indicator light flashes blue rapidly, the restoration is complete.

Power-on reset: In the event of a power outage, use the switch to power on the device for 15 seconds before powering it off. Repeat this power cycle six times consecutively (each cycle consisting of 2 seconds on and 5 seconds off). After the seventh power cycle, the load lamp will flash three times, indicating a successful reset to factory settings.

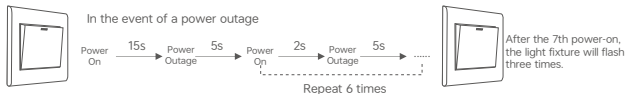

FAQ

What should I do if the device keeps failing to connect?

Please review the following options:

- Ensure the device is properly powered on;
- Keep the phone and device as close as possible, preferably within 15 meters;
- Ensure the device has not been added before. If it was previously added to an Apple Home, locate the “Matter Accessories” option under “General” in the Apple phone’s settings page.

Find the device in the list, delete it, and manually restore the device to factory settings.

Attention

- Product installation and commissioning should be done by a qualified professional.
- Our company products are and not lightningproof non-waterproof(special models excepted). Please avoid the sun and rain. When installed outdoors, please ensure they are mounted in a water proof enclosure or in an area equipped with lightning protection devices
- Good heat dissipation will prolong the working life of products. Please ensure good ventilation.
- Please check if the working voltage used complies with the parameter requirements of products.
- The diameter of wire used must be able to load the light fixtures you connect and ensure the firm wiring.
- Before you power on products, please make sure all the wiring is correct in case of incorrect connection that causes damage to light fixtures.
- If a fault occurs, please do not attempt to fix products by yourself. If you have any question, please contact your suppliers.

Warranty Agreement

- Warranty periods from the date of delivery: 2 years.
- Free repair or replacement services for quality problems are provided within warranty periods.

Warranty exclusions below:

Following conditions are not within the guarantee range of free repairing or replacement services:

- Beyond warranty periods.
 - Any artificial damage caused by high voltage, overload, or improper operations.
 - Products with severe physical damage.
 - Damage caused by natural disasters and force majeure.
 - Warranty labels and barcodes have been damaged.
 - No any contract signed by our company.
1. Repair or replacement provided is the only remedy for customers. Our company is not liable for any incidental or consequential damage unless it is within the law.
 2. Our company has the right to amend or adjust the terms of this warranty, and release in written form shall prevail.
- * This manual is subject to changes without further notice. Product functions depend on the goods. Please feel free to contact our official distributors if you have any question.

单路开关模块

型号: KMS1

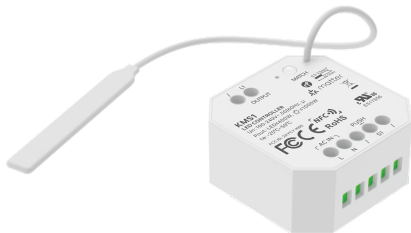

使用说明书

产品介绍

- 全面支持 Apple Home、SmartThings、Google Assistant 及 Amazon 等主流智能家居生态，实现跨平台统一管控。
- 内置Thread模组，兼容Matter协议，支持Siri、Google、Alexa语音控制。
- 支持OTA在线固件升级，持续获得最新功能与安全补丁，保障设备长期可用。
- 通过 NFC Lighting App 即可完成开关类型与上电状态的参数设定。
- 预留机械开关 / 复位开关接口，兼顾传统操作习惯与智能化场景需求。

技术参数

产品型号	KMS1
无线类型	Matter over Thread
开关通道	单通道
工作电压	100-240V~,50/60Hz, μ
继电器最大负载参数	阻性负载: 1000W@230Vac, 500W@110Vac 容性负载: 400W@230Vac, 200W@110Vac
继电器抗浪涌电流	70A@10ms
工作温度	-25°C~50°C
产品尺寸	L45×W45.5×H20.5(mm)
产品重量	38g
执行标准	UL8750、EN 61347-2-13:2014+A1:2017、EN 61347-1:2015+A1:2021、EN 62493:2015/A1:2022

产品图示

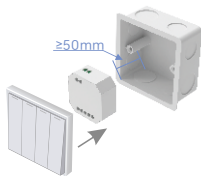
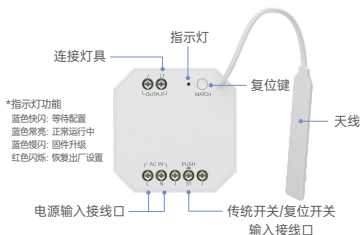

将本产品隐藏于开关暗盒内
*需使用深度 $\geq 50\text{mm}$ 的暗盒安装

产品尺寸

单位: mm

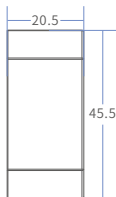
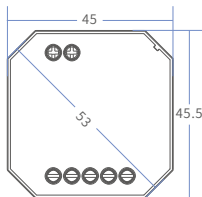

接线应用

1.机械开关接线图

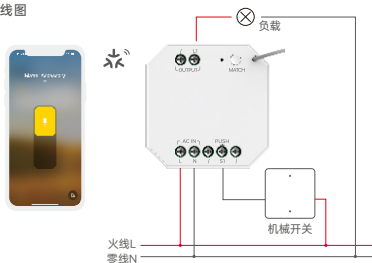

2.复位开关接线图

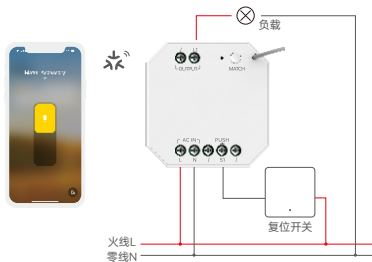

搭配NFC Lighting APP使用

通过手机扫描下方二维码，按提示完成APP安装。(因性能需求，要求手机型号苹果：iPhone8及以上、且操作系统iOS13 及以上；安卓：具备NFC功能机型)



扫码下载APP
IOS/Android



设备NFC感应区

*设置设备参数时，
必须在设备断电情况下进行操作。

1.读取设备

在APP【首页】点击“读/写智能电源”将手机感应区域靠近驱动器NFC感应区，读取设备参数。



2. 编辑参数

点击“参数管理”可选择开关类型，其中选择复位开关时，可设置设备的通电状态功能。



3. 添加到Matter平台说明

1.本设备支持各大主流智能家居平台控制，包括Apple Home、Amazon Alexa、Google Home、SmartThings等。

2.要连接Matter over Thread设备，需要准备各大平台支持Thread边界路由功能的Matter中枢，型号可以查看下图。

 Apple Home	 Google Home	 Amazon Alexa	 SmartThings
Apple HomePod (second-gen)	Google Nest Hub (2nd Gen)	Amazon Echo (4th-gen)	Aeotec SmartThings Smart Home Hub
Apple HomePod Mini	Google Nest Hub Max	Amazon Echo Hub	Samsung SmartThings Station
Apple TV 4K (2nd gen)	Google Nest Wifi Pro	Amazon Echo Show 8 (3rd-gen)	Samsung SmartThings Hub Dongle
Apple TV 4K (3rd gen, 128 GB)	Google TV Streamer (4K)	Amazon Echo 6, Pro 6, 6 Plus, Max 7 etc.	Samsung SmartThings Hub v3

3.本说明书以Apple Home为例，请先准备一台装有最新版本固件的 iPhone (iOS 16.2 或更高版本) 或 iPad

(iPadOS 16.2 或更高版本)，以及一台装有最新版本固件的 Apple HomePod mini。然后将 iPhone 或 iPad 连接
*如苹果手机型号是iPhone 15及以上，则无需Matter中枢，可直接添加。
到您的家庭 WLAN 网络，运行 Apple Home 应用程序并按照 Apple 的指示设置 HomePod mini。

4. 添加配件

打开Apple Home app，并点击“添加或扫描配件”，通过扫描设备上的二维码贴纸，将设备添加到Apple Home，如下图所示。



*也可以通过NFC入网：使用iPhone 16及以上型号的苹果手机可直接靠近设备的NFC感应区域，可以被识别并可入网。

5. 控制设备

设备成功添加到Apple Home后，点击设备图标进行开/关。



6. 高级功能

支持创建组、场景、自动化、进行远程控制和定时控制，也可以通过Siri语音指令控制设备。



7. 恢复出厂设置

复位键复位: 长按复位键 15 秒，待指示灯变为红色快闪后松开；3 秒内短按复位键 3 次，此时红灯转为慢闪，设备开始恢复出厂设置；指示灯变为蓝色快闪时，即恢复完成。

断上电复位: 在断电的情况下，使用开关让设备通电15秒后断电，再连续通断电6次（每次通电2秒，断电5秒），第7次通电后，负载灯具闪烁3次，即表示已恢复到出厂设置状态。

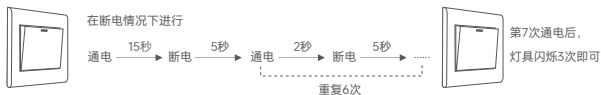

常见问题

设备一直搜索不到怎么办？

请检查以下选项：

- 确保设备正常通电状态；
- 确保手机与设备两者尽量靠近，建议不超过15米；
- 确保设备未被添加过，如被添加过苹果家庭，需在苹果手机设置页找到“通用”选项中的“Matter配件”选项，查找其中的设备列表并删除该设备同时手动恢复出厂设置。

注意事项

- 请由具有专业资格的人员进行调试安装；
- 我司产品（专有型号除外）不能防水防雷，需避免日晒雨淋，如安装在户外，请用防水箱和防雷装置；
- 良好的散热条件会延长产品的使用寿命，请把产品安装在通风良好的环境；
- 请检查使用的工作电压是否符合产品的参数要求；
- 使用的电线直径大小必须能足够负载连接的LED灯具，并确保接线牢固；
- 通电调试前，应确保所有接线正确，以避免因接线错误而导致灯具损坏；
- 如果发生故障，请勿私自维修；如果有疑问，请联系供应商。

保修条例

- 自出厂之日起保修服务期为2年。
- 在保修服务期内出现产品质量问题我司将给予免费修理或更换服务。

非保修条例：

属下列情况不在免费保修或更换服务范围之内：

- 已经超出保修期限的；
- 过高电压、超负载、操作不当等人为造成的损坏；
- 产品外形严重损坏或变形；
- 自然灾害以及人力不可抗拒原因造成的损坏；
- 产品保修标签和产品唯一条形码损坏；
- 无我司签订的合同或发票凭证。

1. 修理或更换是我司对客户的最唯一补救措施。我司不承担任何附带引起的损害赔偿，除非在适用法律范围之内。
2. 我司享有修正或调整本保修条款的权利，并以书面形式发布为准。

* 本说明书的内容如有变更，恕不另行通知。若内容与您使用的功能有所不同，则以实物为准。
如有疑问，欢迎向我司授权的经销商咨询。